

The Borough of Edinboro- Zoning and Building Department

124 Meadville Street // Edinboro, PA 16412 // (814) 734-1812 x 139 / (814) 734-4492 (fax)  
jrhen@edinboro.net / mjones@edinboro.net



**Zoning Application ~ Fence / Retaining Wall**

Property Address: \_\_\_\_\_ Zoning District: \_\_\_\_\_

Parcel #: \_\_\_\_\_ Property type: \_\_\_\_\_

Property Owner: \_\_\_\_\_

Owner Address: \_\_\_\_\_

Phone: \_\_\_\_\_ Cell: \_\_\_\_\_ Email: \_\_\_\_\_

Contractor: \_\_\_\_\_ PA Reg #: \_\_\_\_\_

Contractor Address: \_\_\_\_\_

Phone: \_\_\_\_\_ Email: \_\_\_\_\_

**Project:** Fence  Retaining Wall  /// New  Replacement  /// Height \_\_\_\_\_ Length: \_\_\_\_\_

Style: Picket  Stockade  Other  \_\_\_\_\_ /// Material: Wood  Vinyl  Stone  Block

Cost: \$ \_\_\_\_\_ /// Start date: \_\_\_\_\_ **CALL BEFORE YOU DIG PA One Call 811**

**Section 403.3 Borough Zoning Ordinance 457**

*A wall or fence under 6 feet 6 inches in height and paved terraces without walls, roofs or other enclosures may be erected within the limits of any yard. Retaining walls and fences required for screening under this Chapter are not subject to the 6-foot high limitation. Fences may be permitted in front yard areas provided they are no higher than 4 feet and do not obstruct the required free sight triangle at intersections. Fences shall be constructed in accordance with Borough Codes. Fences shall not be electrified, use spikes, broken glass, barbed wire or similar material designed to injure persons who attempt to climb them.*

- Provide a sketch plan for the work to be completed.
- It is recommended fences be installed with finished side facing out.
- You may install fence up to property line (no setback is required). If there is doubt where the property line is located, a land survey is strongly advised.
- The Borough of Edinboro does not perform land surveys. It is the responsibility of the property owner to obtain those services from licensed private professional land surveyors.
- If you have questions please contact the Building Code Department.
- ° Retaining walls may require a building permit.

\_\_\_\_\_  
Owner or Contractor Signature

\_\_\_\_\_  
Date

---

**Building & Zoning Department Only - (Fines may be assessed for starting work without permit)**

Flood zone: \_\_\_\_ / Site Plan: \_\_\_\_ / Building Permit \_\_\_\_ / Fines \_\_\_\_\_

Received: \_\_\_\_\_ Approved  - Denied  - Additional Information Requested

Permit #: \_\_\_\_\_ Invoice #: \_\_\_\_\_ Notes: \_\_\_\_\_

Payment: \$25 Cash  - Check  (NO. \_\_\_\_\_) - Money Order  - Charge

\_\_\_\_\_  
Building & Zoning Administrator

\_\_\_\_\_  
Date

\_\_\_\_\_  
Owner/contractor contacted to  
pick-up permit/placard



# Sample Sketch

\* Plot all structures (House/Garage/ Sheds/ Decks/ Fence/ Walks/ Driveways

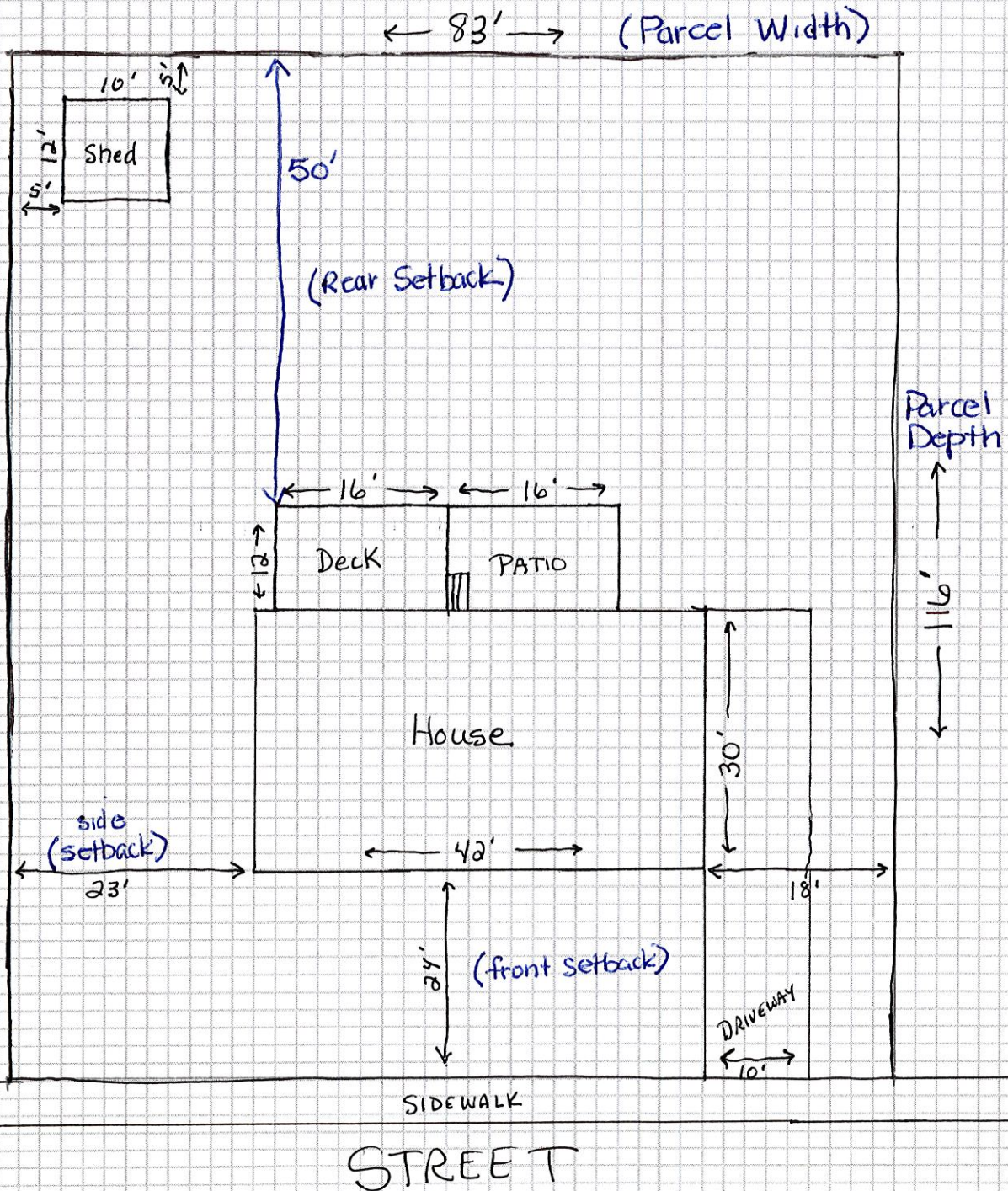

Block: 2 Sq Ft

Lot Size: 83' x 116'

Property Address: